

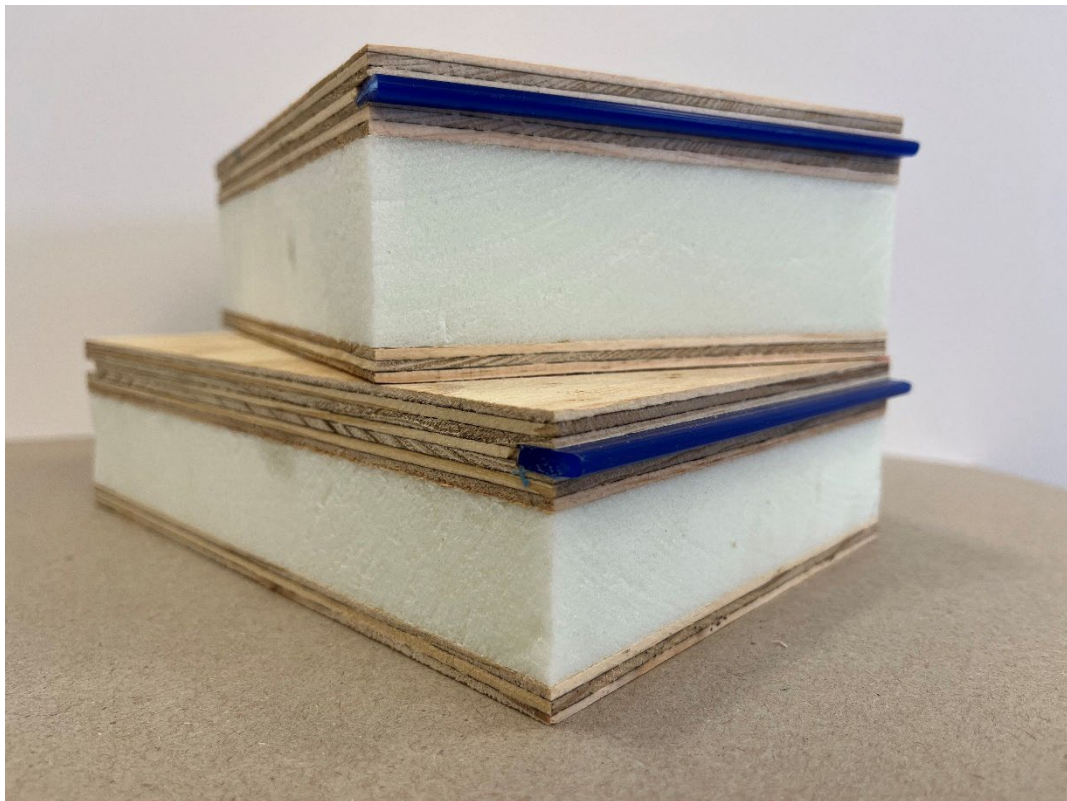

# INSTALLATION GUIDE



**Product details:**

**Top skin:** 17mm T&G Structural Plywood Australian Production

**Bottom skin:** 7mm Structural Plywood Australian Production

**Core:** Australian Manufactured Foam Core

Standard sizes available:

2400x1200x54mm

2400x1200x64mm

Other thickness available on request with additional lead times see table below for reference.

**Sub Floor Requirements:**

Platinum “R” Floor panel system can be installed over either steel or timber joists, their size and spacing are to be determined by the project engineer, recommended maximum joist centres 800mm. It is recommended that the joists have a minimum thickness of 45mm. The Platinum “R” Floor panels can be easily installed using existing standard steel and timber joist framing systems that are available throughout Australia.

When using timber joist systems for residential construction, it's important to ensure that the manufacturer's specifications comply with AS 1684.2 'Residential Timber-Framed Construction.

**Blocking is required under all load bearing walls.**

**Fasteners & Fixing:**

We recommend the use of a Countersunk, Ribbed Head, Square Drive, 10-gauge Screw, length dependent on the panel thickness, see table below. Note: Class/ Coating of screw will be dependent on location of build.

5mm bead of adhesive to be applied on joists tops - Bostik Ultraset SF or equivalent.

**Do not over tension screws when fixing floor panel**, any over driven screws that compress panel need to be backed off and let panel decompress.

Screws to be no more than 150mm apart around perimeter and 300mm through centre of sheet to joists. As per drawing on page 3:

Platinum R Floor	Steel Joists		Timber Joist
Panel Thickness	Steel Thickness approx. 1.15mm	Steel Thickness 2.8mm and over	Screws (Gauge, Root Diameter, Length)
R1.18 = 54mm	10-16-75mm	10-16-75mm	10G x 75mm
R1.50 = 64mm	10-16-100mm	10-16-100mm	10G x 100mm
R1.73 = 74mm	10-16-125mm	10-16-125mm	10G x 125mm
R2.03 = 84mm	10-16-125mm	10-16-125mm	10G x 125mm
R2.48 = 99mm	10-16-150mm	10-16-150mm	10G x 150mm

**Please note:** this product cannot be fixed using nails. Please ensure all installations align with local council and state regulations. Adhere to the minimum requirements outlined in Section 10 of AS/NZS1860.2.

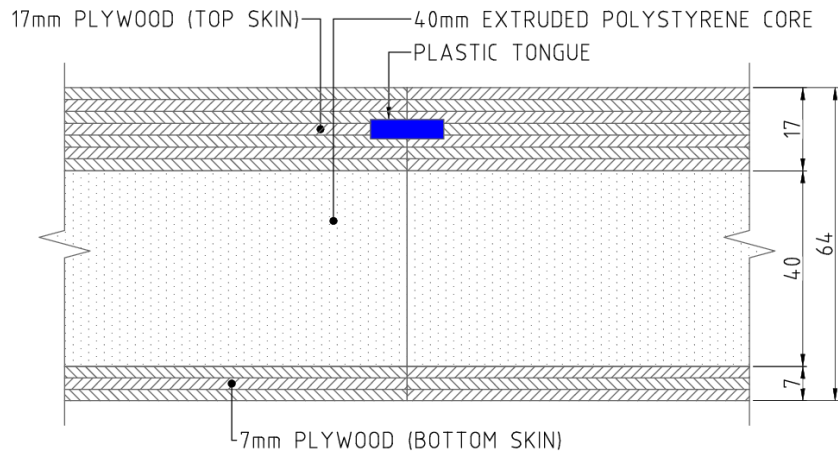

FLOORING PANEL - SECTION  
SCALE NTS

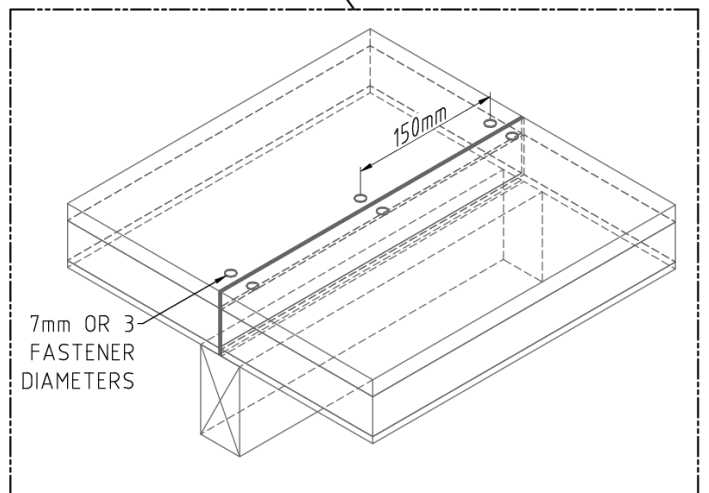
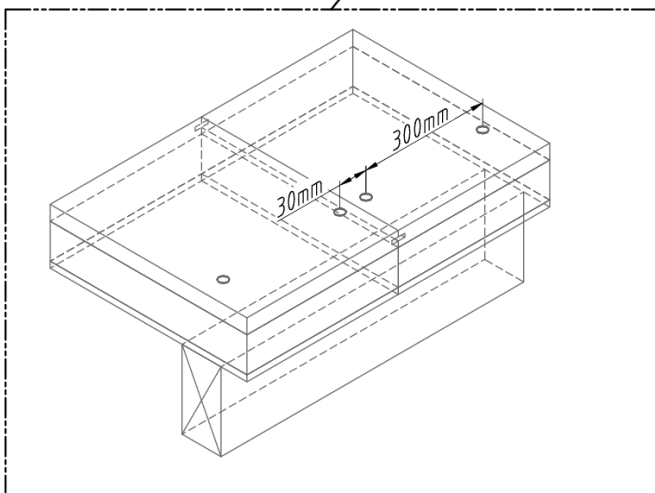
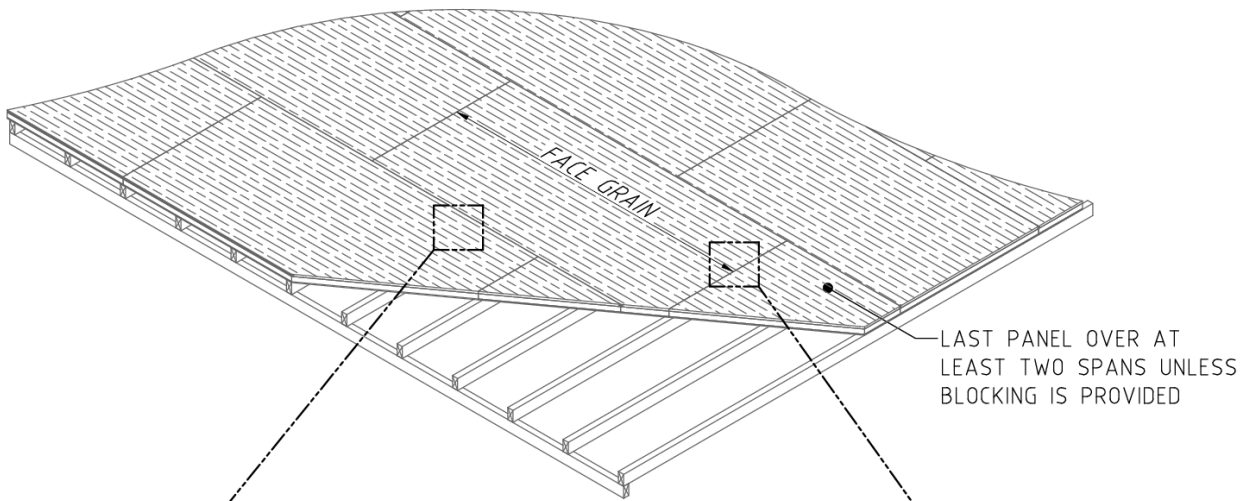
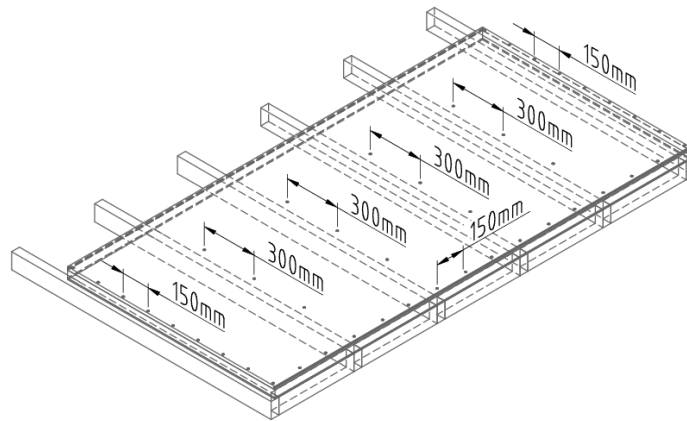

**Tools Required:**

Level/ Straight Edge  
Caulking gun  
Circular saw or Jigsaw  
Combination square  
Hammer

Measuring tape  
Pencil  
Chalk Line  
Drill/ Impact driver

**Safety Precautions:**

Required PPE: Safety Glasses, Dust Mask, Work Gloves, Hearing Protection

Always wear safety glasses, a dust mask, and work gloves during the cutting process to protect yourself from flying debris and dust.

Use dust extraction on saws wherever possible.

Ensure the work area is well-ventilated to prevent the accumulation of sawdust and other debris.

By following these instructions and using the necessary tools and PPE, you can install Platinum “R” Floor panels and be confident it is stable, and long-lasting for many years to come.

Ensure that the saw blade is sharp, properly adjusted and set to the correct depth.

Use clamps to securely hold the panel in place during the cutting process.

Take breaks as necessary to allow the saw blade to cool and prevent overheating.

**Cutting Platinum “R” Floor panels:**

Set the saw blade depth to 3mm greater than the thickness of the panel.

Place the panels on sawhorses, ensure that panels are clamped down securely.

Use a straightedge, guide or track saw to ensure a straight and accurate cut, especially for longer cuts.

Begin the cut at a slow speed, following the marked dimensions with the saw blade.

After completing the cut, remove any sawdust or debris from the panel.

Allow the saw blade to cool periodically to avoid overheating.

## Installation:

Measure the room's length and width and determine the centre point of the room.

Snap a chalk line from the centre of one wall to the centre of the opposite wall to create a guideline for the first row of Platinum "R" Floor panels.

Place the first sheet of Platinum "R" Floor panels with its edge along the chalk line and secure it to the subfloor with screws. Ensure the panel is flush with the walls and square to the subfloor.

Continue laying the first row of Platinum "R" Floor panels, ensuring the panels are tightly butted together and fastened securely to the subfloor. Do not over tighten screws when fixing, any over driven screws should be backed off until set just below surface.

Cut the last sheet in the first row to fit using a circular saw.

Begin the second row with a half sheet of Platinum "R" Floor panels to stagger the seams and repeat the process for the remaining rows until the entire floor is covered.

Cut any remaining Platinum "R" Floor panels to fit around obstructions such as vents or doorways.

**Blocking is required under all load bearing walls.**

## Wet Area Set Down:

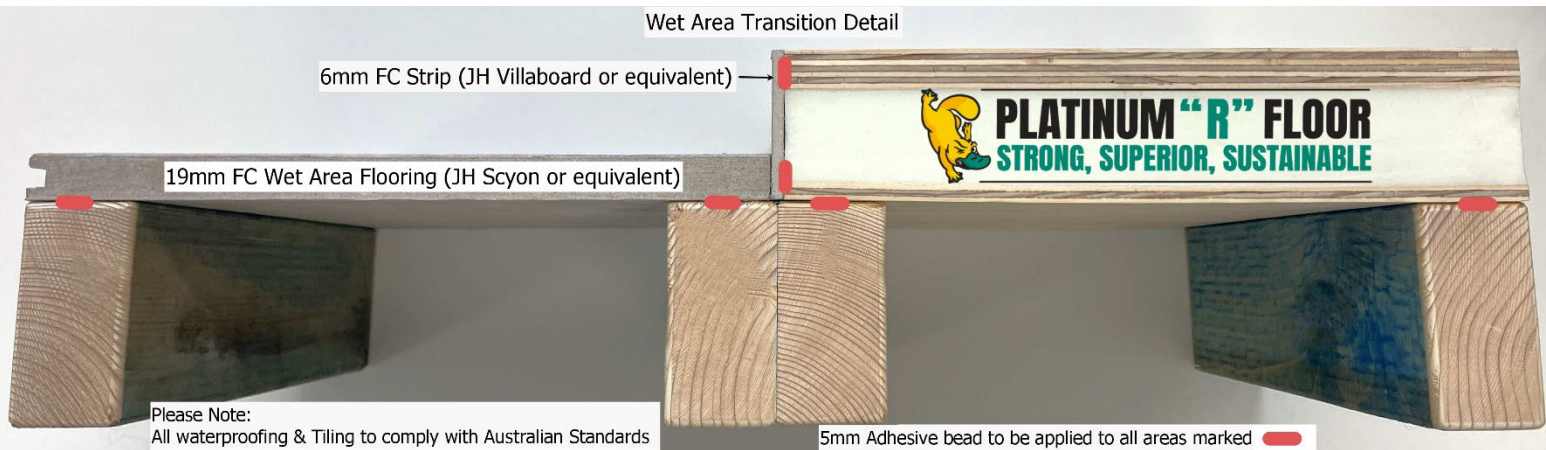

## Storage and Handling:

It's important to take care when storing and handling Platinum "R" Floor panel products. Please protect the edges and corners of the product from damage during storage. Also, make sure that the products are kept dry and away from weather during both transport and storage.

To prevent any unnecessary exposure to water or moisture, the product must be laid flat on a smooth, level surface that is clear of the ground. This will help to avoid any damage and ensure that the product stays in good condition prior to installation.

**Australian Made:**

Platinum “R” Floor panels are proudly 100% Australian made and have been certified by Australian Made Campaign Limited (AMCL).



**Disclaimer:**

This document contains information that is provided by Platinum Timber & Ply, which is believed to be accurate and dependable at the time of preparation. However, Platinum Timber & Ply does not assume any responsibility for errors or omissions contained herein. The information provided in this document should not be construed as a recommendation to use any of Platinum Timber & Ply's products in violation of any patent rights or in breach of any statute or regulation.

It is important to note that Platinum Timber & Ply makes no representations as to the suitability of the product for the customer's requirements. Therefore, it is the responsibility of the users to determine the suitability of this information in relation to their particular purpose and specific circumstances. Moreover, as the information contained in this document may be applied under conditions beyond the control of Platinum Timber & Ply, it denies any liability for any loss or damage that may be caused by any person acting or refraining from action as a result of this information.

By accessing this information, users acknowledge that they have read and understood the terms and conditions set forth herein and agree to be bound by them.



---

# PLATINUM “R” FLOOR

## STRONG, SUPERIOR, SUSTAINABLE

---

**Proudly manufactured & distributed by Platinum Timber & Ply Pty Ltd**

5 Aliciajay Circuit

Luscombe QLD 4207

07 3803 7488

[Sales@platinumtimber.com.au](mailto:Sales@platinumtimber.com.au)

[www.platinumtimber.com.au](http://www.platinumtimber.com.au)



**Platinum  
Timber & Ply**



**Responsible  
Wood** RW/1-10-1

